



**Tera Manufacturing, Inc.**  
5251 South Commerce Dr.  
Murray, Utah 84107  
Phone/801.288.2585  
Fax/801.288.2571  
www.teraflex.biz

## *Installation instructions for the Heavy Duty Short Shaft Kit (231SS) (slip yoke eliminator kit)*

1987 models to present

Reference numbers in **BOLD** refer to fig. #3 attached.

A new rear drive shaft is required once this kit has been installed on the vehicle.

This yoke kit is installed easiest if the transfer case is removed from the vehicle. This way, the NP231 can be set in a vertical position on a bench making disassembly and assembly much easier and faster.

Jeep Cherokee applications:

XJ vehicles with a front-axle vacuum disconnect switch will require the use of the 5/8"x18 threaded hole located on the new rear bearing retainer housing.

Low-Range Conversions

If a TeraLow Low231 low-range conversion is being used, the switch can be placed in the front of the housing.

### **Instructions:**

1. Put vehicle in gear and engage the emergency brake.  
Remove the drain plug on the NP231 and drain all of the fluid.
2. Remove the front and rear drive shafts from the vehicle.
3. Remove the front driveshaft yoke from the transfer case.
4. Remove the three metric bolts holding the rear seal retainer housing to the transfer case. Pry the rear retainer housing carefully to remove it from the transfer case. On TJ applications, remove the rubber boot and the stamped shield.
5. Using snap ring pliers, remove the bearing retainer snap ring (**#55**) from the NP231 main shaft. Also, disconnect the speedometer cable from the t-case and remove the speedometer drive gear assembly from the rear bearing retainer housing.
6. Remove the metric bolts that attach the rear bearing retainer housing (**#59**) to the rear case half. Gently pry up the retainer and remove it.
7. At the rear of the case, you will notice a protruding steel rod. This rod is actually the end of the shift rail assembly (**#47**). As the transfer case is shifted from one gear to another, this shift rail will move forward or backward. Using a pair of pliers or wrench, shift the transfer case until the exposed end of the shift rail is as far out as it will go. Place the new bearing retainer housing onto the rear case half as would occur during final assembly. Verify that the protruding shift rail does not bottom out into the pocket of the new bearing retainer housing. If interference does occur here, remove the new housing and shift the t-case until the shift rod is as far in as it will go. Using a cut-off wheel



or grinder, cut the rail flush with the bushing (in the rear case half) that holds the rod in the case.

- Remove the bolts holding the two transfer case halves (#3 & #49) together. Separate the case halves with a screwdriver using the indentations available on both sides of the t-case. The pump (#32) will be removed with the rear case half (#49).
- Slide the shift rail spring off the shift rail (#48). See the figure below.

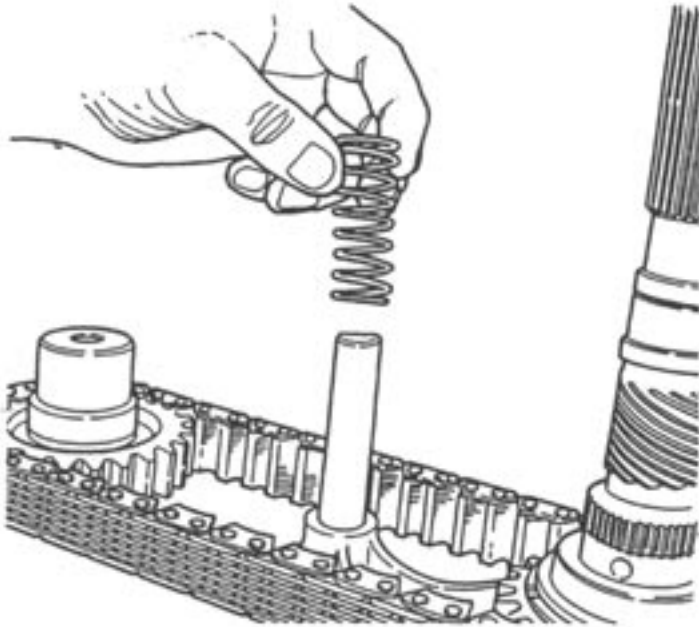

10. Holding the mainshaft and front drive sprocket, slide the entire assembly (chain included) rearward and out of the transfer case. The shift fork will come out with the assembly. See figure below.

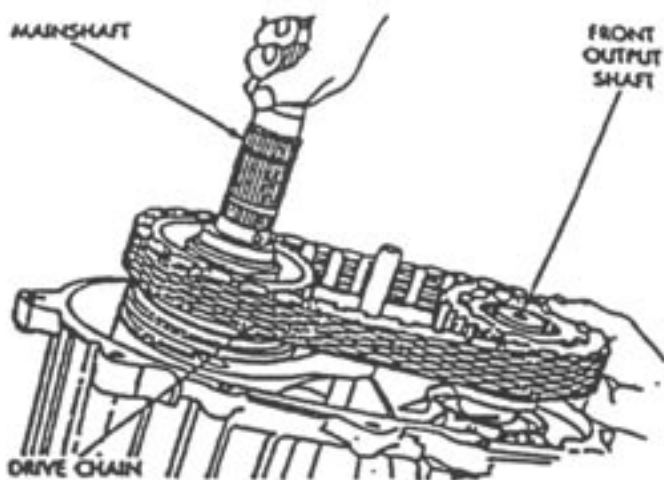

11. On the mainshaft, remove the snap ring (#14) holding the drive gear/synchronizer assembly in place. Slide the assembly down off of the shaft.
12. Slide the drive gear/synchronizer assembly down onto the new mainshaft supplied in the kit.

13. Place the flat shim (supplied in the kit) on top of the gear assembly by passing it over the mainshaft. This shim will now be located directly below the snap ring groove in the mainshaft.
14. Install the snap ring that was removed in step 11. A new snap ring is provided in the kit if you choose to use it. For reference, the shim (step 13) should now be located between this snap ring (#14) and the gear/synchronizer assembly (#17).
15. Place the mainshaft and chain assembly back into the t-case directly opposite of how it was removed in step #10.
16. Place the shift rail spring (removed in step 9) over the end of the shift rail.
17. Properly clean the case half mating surfaces with non-petroleum based cleaner (alcohol or brake part cleaner). When dry, apply a 3mm (1/8") bead of high temp. RTV sealer/silicon to the seal surface on the front case half. Be sure the case locating dowels are in place and that the mainshaft splines are engaged in the oil pump's inner gear. Install and tighten the front case (#43) to the rear case (#49) attaching bolts. Torque to 30 ft-lbs.
18. There are two more small snap rings supplied in the kit. Both rings are for the blue, speedometer gear also included with the kit. First, install one of the rings in the lower groove on the main shaft until it rests on the lower snap ring. Install the second snap ring onto the shaft just above the plastic gear. Refer to Figure 4 for the locations of snap rings.
19. Press the new output bearing into the new bearing retainer housing.
20. Install the output bearing retainer snap ring on top of the bearing installed in step 19.
21. Using silicon, lay a small 1/8" bead around the outer edge of seal, and press the new oil seal into the rear bearing retainer housing (see Figure 4).
22. With the gasket surfaces clean, silicon the new rear housing assembly on the rear of the t-case. Use a 3mm (1/8") bead of silicon and torque to 30 ft-lbs. This new retainer replace the original retainer removed in Step 6. Bolt this housing in place. Refer to Figure 4 for housing location.
23. Reinstall the speedometer drive gear assembly into the new rear housing. Rotate the speedometer drive gear insert until proper engagement is achieved.  
(Note: There are four different positions - only one will work depending on which drive gear you have.)
24. Install the yoke spacer on mainshaft prior to installing the rear output yoke. Refer to Figure 4. Install the front and rear output yokes onto the NP231. Fill with automatic transmission fluid (Dexron III).

Figure 4

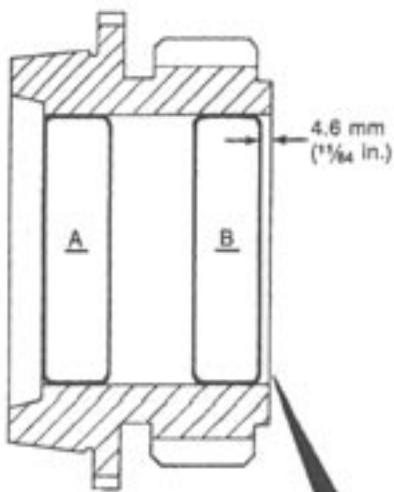
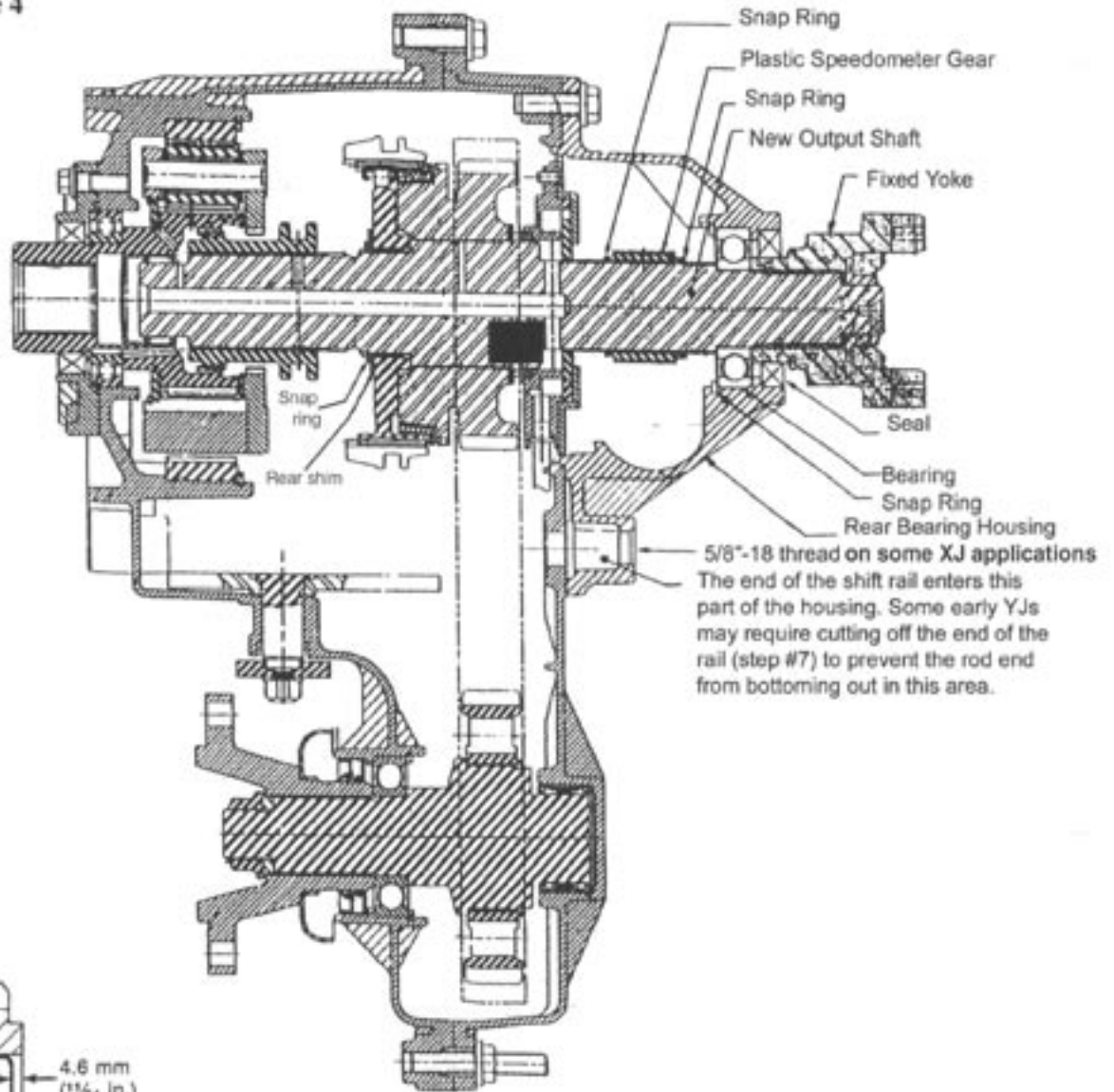

If necessary, install bearings into the drive sprocket as indicated in the diagram to the left. The diagram to the left is the same part as #23 on the exploded view of the NP231 transfer case.

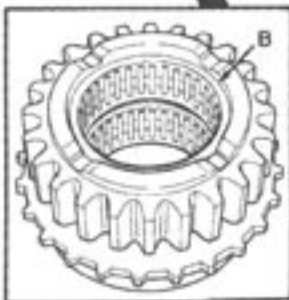

# Exploded View of the NP231 Transfer Case

- Included in the Tera Low231 Heavy Duty Short Shaft kit

**Note:** This diagram shows the Tera Low231 Heavy Duty Short Shaft kit, Tera Low231 4.0:1 case, and the Tera Low2WD kit. A stock setup will appear different than pictured.

1. Front input seal
2. Front bearing retainer and seal
3. Tera HD Low231 case
4. Vacuum switch and seal
5. Vent assembly
6. Input gear bearing and snap ring
7. Low-range gear snap ring
8. Input gear retainer
9. Low-range gear thrust washer
10. Input gear
11. Input gear pilot bearing
12. Planetary gear assembly
13. Range fork shift hub
14. Synchro hub snap ring
15. Shim
16. Synchro hub springs
17. Synchro hub and inserts
18. Synchro sleeve
19. Stop ring
20. Shift detent plug, spring, and pin
21. Snap ring
22. Front output shaft bearing
23. Front output shaft
24. Large snap ring
25. Shim
26. Drive sprocket
27. Drive chain

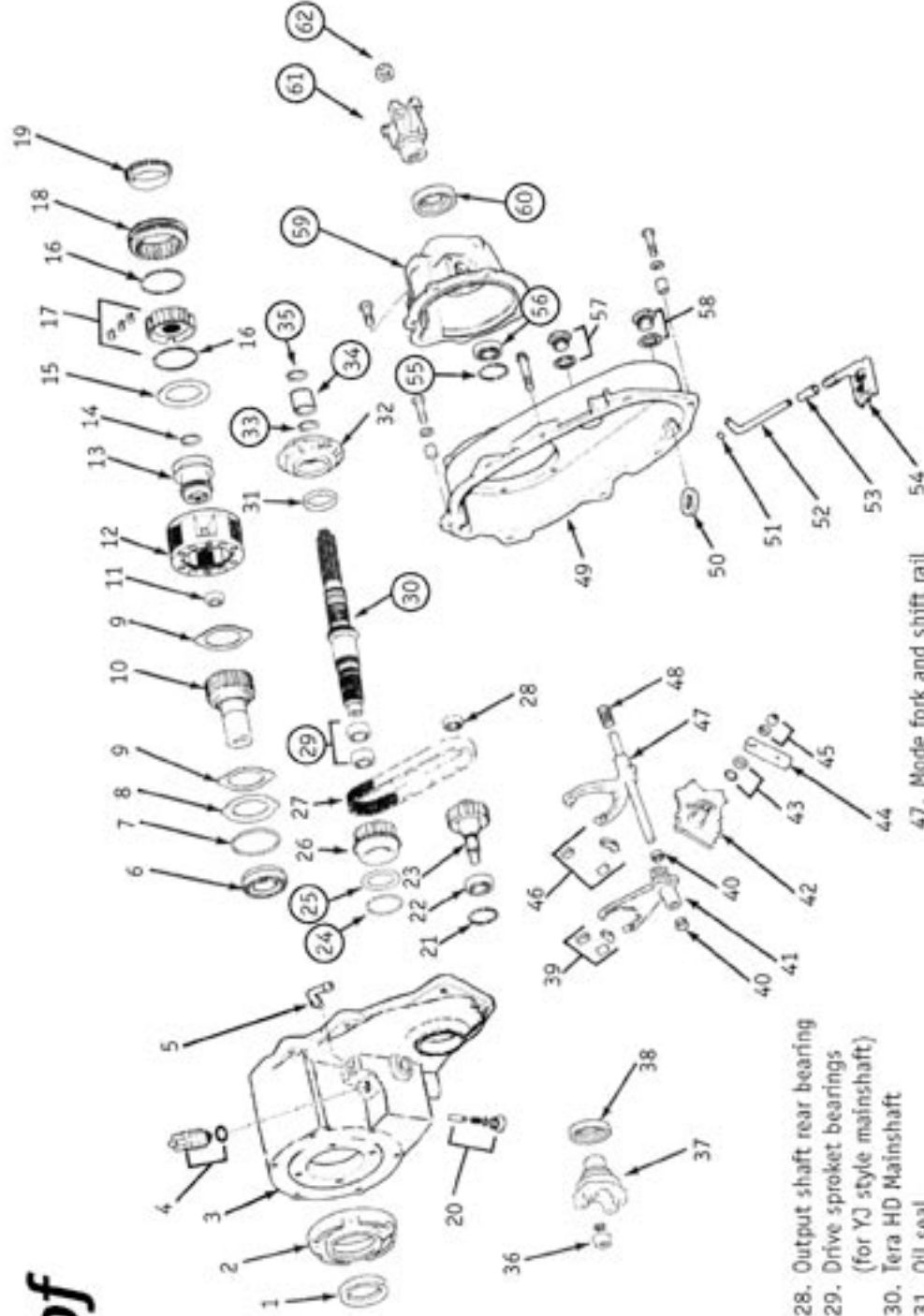

28. Output shaft rear bearing
29. Drive sprocket bearings (for YJ style mainshaft)
30. Tera HD Mainshaft
31. Oil seal
32. Oil pump assembly
33. Snap ring
34. Speedometer drive gear
35. Snap ring
36. Front yoke nut
37. Front yoke
38. Front output seal
39. Range fork inserts
40. Range fork bushings
41. Range fork
42. Sector
43. O-ring and seal
44. Range lever
45. Range lever nut and washer
46. Mode fork inserts

47. Mode fork and shift rail
48. Mode spring
49. Rear case
50. Magnet
51. Pickup tube oil ring
52. Mode fork inserts
53. Tube connector
54. Oil pickup screen
55. Snap ring
56. Rear bearing
57. Fill plug and gasket
58. Drain plug and gasket
59. Rear housing
60. Rear output seal
61. Rear yoke
62. Rear yoke nut



**Tera Manufacturing, Inc.**  
5247 South Commerce Dr.  
Murray, Utah 84107  
Phone/801.288.2585  
Fax/801.288.2571  
www.teraflex.biz